

EDMONTON GOLF SHOW		EDMONTON GOLF SHOW	
Current Registrants (Click on the exhibitor to learn more)	Booth #	Current Registrants (Click on the exhibitor to learn more)	Booth #
Alberta Golf	32/D1	Golf Vancouver Island	3/4
Alberta Golf Tour	12	Goose Hummock GR	25
Allstate Insurance	22	Highlands GC	19
Bcgolfguide.com	39	Investors Group Financial Services Inc.	27
Canada Golf Card	29/30	Jasper Park Lodge GC	7
Coal Creek GR	11	Kootenay Golf Trail	33/34/35
Columbia Valley Golf Trail	43/44	Play Golf Alberta	1/2
Copper Point GC	42	Shadow Mountain GC	47
Copper Point Resort	41	Shaw Charity Classic	26
Cougar Creek GR	17	St. Eugene Golf Resort Casino	36
Coyote Creek Golf & RV Resort	9	Sturgeon Valley G&CC	21
Eagle Point GC	10	Telus	37
Edmonton CC	8	The Quarry	18
Edmonton Garrison Memorial G&CC	5	The Ranch G&CC	6
Edmonton Shockwave Therapy	46	Time Share Exit Team	28
Edmonton Sun	48	Totem Golf	23/24
Elle Golf	31	Tourism Kimberley	40
Golf Kamloops	38/45	Trestle Creek GR	15/16
Golf Kelowna	13/14	Whitecourt G&CC	20

Driving Range Exhibitors	Booth #
Callaway Golf	D3/D4
Cobra Puma Golf	D5
Krank Golf	D6
PING Canada	D2
Mizuno Canada	D8
Wilson Sports Equipment	D7

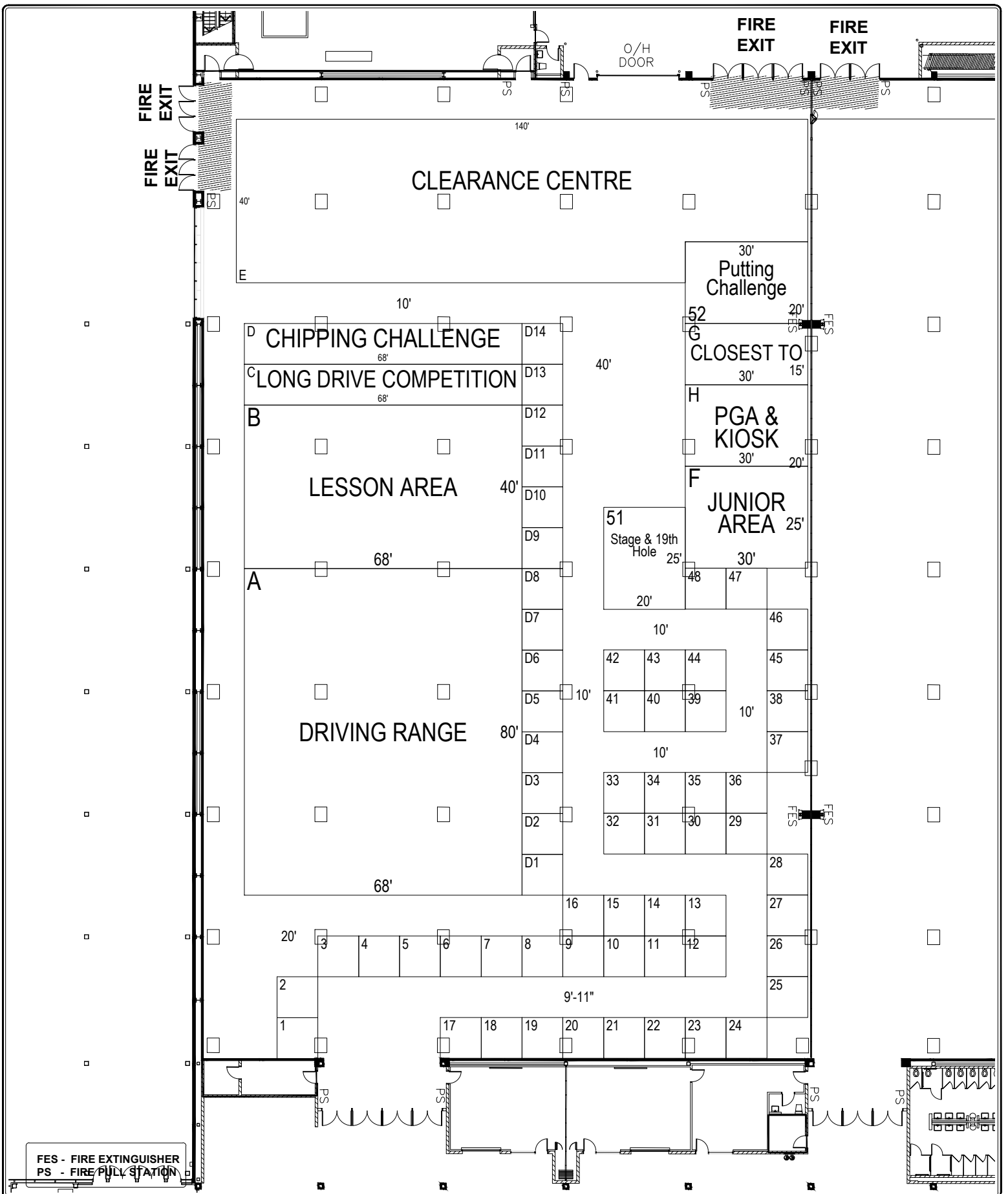

FES - FIRE EXTINGUISHER
PS - FIRE PULL STATION

COPYRIGHT © 2009 GES CANADA

All Rights Reserved. No part of this publication may be reproduced, stored in any retrieval system, or transmitted in any form or by any means - electronic, mechanical, photocopying, recording, or otherwise - without the express written consent of GES CANADA.

Every effort has been made to insure the accuracy of all information contained on this floor plan. However, no warranties, either expressed or implied, are made with respect to this floor plan. If the location of building columns, utilities, or other architectural components of the facility is a consideration in the construction or usage of an exhibit, it is the sole responsibility of the exhibitor to physically inspect the facility to verify all dimensions and locations.

PGA of Alberta Edmonton Golf Show

March 11-12, 2017

Edmonton Expo Centre, Edmonton

Hall H

Confidential Property Of GES CANADA

File: APGA_2017_spring.dwg

Layout: GUIDE P

Plotted: November 28, 2016, 3:03:14 PM

By: Pucci, Tammy

